

IndiGo

independent showering



INSTRUCTION MANUAL

General operation

APPLIES TO ALL MODELS

IndiGo Drive
IndiGo Drive T
IndiGo Drive HT
IndiGo Drive Plus
IndiGo HT
IndiGo HTM
IndiGo HTR
IndiGo Plus HT
IndiGo Plus HTX

Headrest



Armrest



To fit/remove the armrest lift and align the cut out with the bolt to allow the armrest to slide on or off.

Footrest

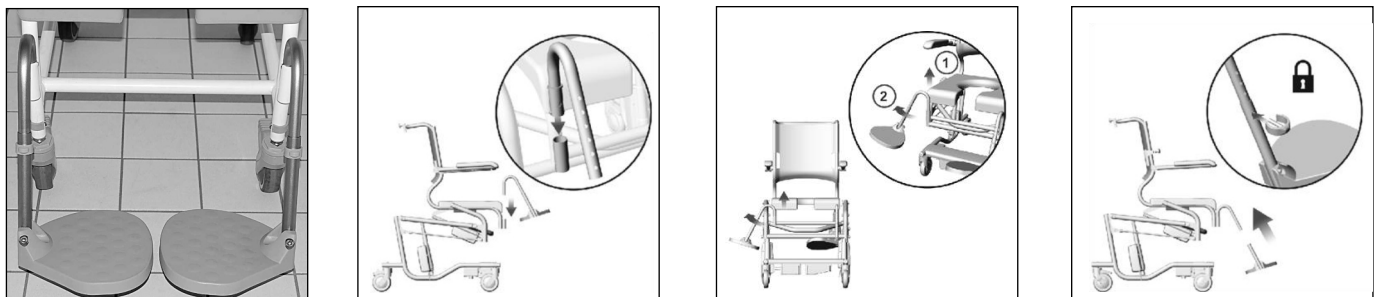

The height of the footrest is adjusted by clips. For extra space, footrests can be pushed aside by lifting and turning, while the footrests can be tilted

Backrest

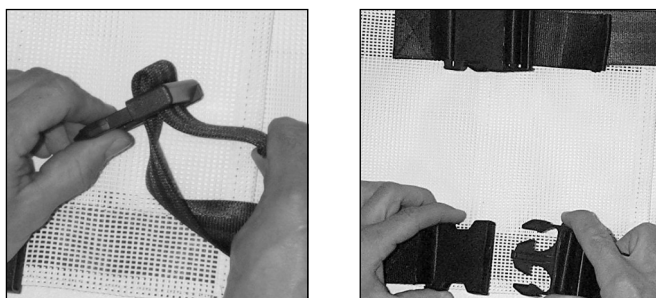

Adjust the backrest using the clips. Wash at 80 degrees max.

General operation - continued

APPLIES TO ALL MODELS

IndiGo Drive
IndiGo Drive T
IndiGo Drive HT
IndiGo Drive Plus
IndiGo HT
IndiGo HTM
IndiGo HTR
IndiGo Plus HT
IndiGo Plus HTX

Calf support

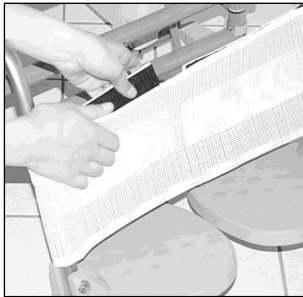

Secure and adjust with the Velcro strip on the back.
Wash at 80 degrees max.

Side supports

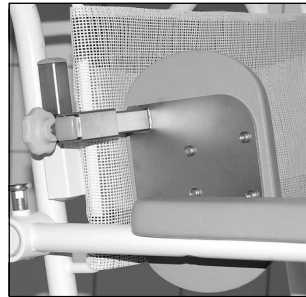

Adjust the position using the thumb screw.

Urine bucket

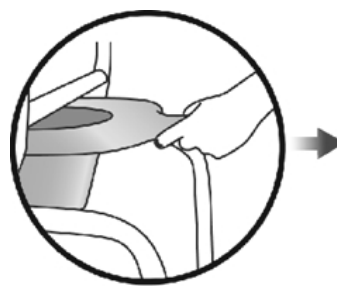

To remove the urine bucket pull outwards using a steady motion.

Safety

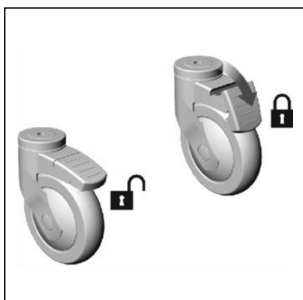

Castors can be locked/unlocked by applying pressure to the brake using a foot.



Avoid sitting on the last 10cm of the seat, as the chair may tip forward.



Do not stand on the footrests.

Cleaning

The chair can be cleaned with regularly with a non-abrasive detergent and water up to 85° degrees in around 3 minutes. Dry the chair after the cleaning.

Electric Drive

APPLIES TO THE FOLLOWING MODELS

IndiGo Drive
IndiGo Drive T
IndiGo Drive HT
IndiGo Drive T Plus

Joystick



To move: Point the joystick in the direction you want to go.

To Stop: Release the joystick - the rear wheels will be braked automatically.



The speed of the chair is adjusted by turning the dial left to decrease speed or right to increase speed.



A light on the joystick indicates how much charge is in the battery.

Charge the battery if the indicator no longer lights.

To prevent personal injury do not use the chair if the protective cases around the electrical parts are damaged. Damaged protective cases must be replaced with original parts before using the chair and to prevent further damage to electrical components.



The chair is equipped with a horn, which is activated by pressing the button.



The joystick can be positioned for access by the user or for the carer. Use the thumbscrew to fix the joystick to the chair.



Charging

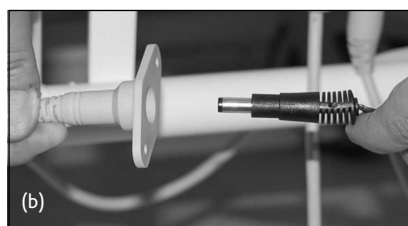
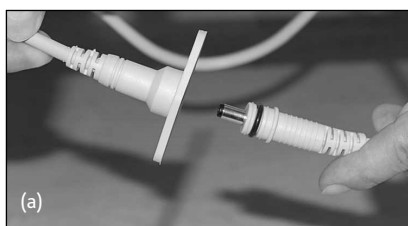

The battery should be charged for 24 hours before first use.

A full charge takes around 8 hours, when the battery is running low it will make a beeping sound. The battery can be damaged if you let it run completely out of power.

To charge the battery remove the power plug from the battery box (a) and insert the charger plug (b). Do not turn on the switch before the charger is connected to the chair.

Battery LED indicator: Orange = Charging | Green = Charged

Note: If the light on the charger lights up green when first connected, there is a problem with the battery, charging cable or the charger and it must be changed.

Do not:

- use the chair while charging or connected to a power supply.
- charge the chair while being used in areas with water.
- use the electrical functions while spraying with water.

Damaged electrical parts: To prevent personal injury do not use the chair if protective cases or electrical parts are damaged. Damaged parts must be replaced with original parts before using the chair and to prevent further damage

Electric Height and Tilt

APPLIES TO THE FOLLOWING MODELS

IndiGo Drive HT
IndiGo HT
IndiGo HTM
IndiGo HTR
IndiGo Plus HT
IndiGo Plus HTX



The hand control

The hand control is used to electrically adjust the tilt and height of the chair.

Use the left arrow button to tilt the chair forwards and the right arrow button to tilt the chair backwards.

Use the up arrow button to raise the chair and the down arrow button to lower the chair .

Charging

To charge connect to a power supply.

When charging, the 4 LED lights will light up then flash continuously.

When fully charged the LED will light up continually.

Remaining power level is indicated by the battery symbols 1, 2, 3.

LED 1 = 10 - 20 %

LED 2 = 21 - 40 %

LED 3 = 41 - 100 %.

Low power - When only LED 1 is lit the control box will beep to indicated that the chair must be charged.

The power plug is located without the white cover on the front of the chair.

Power save mode

If the chair or hand control is not used, the LEDs on the hand control are switched off.

Errors / resetting the chair

In the event of an error all the LEDs on the hand control will light up and the chair will need to be reset. To reset the error follow steps 1 & 2:

Step 1) Hold down the "STOP" button on the hand control until the two LEDs either side of the arrow keys light up

Step 2) Hold down the emergency red "Arrow down" button on the hand control until the chair is automatically lowered to the bottom.
Note: The chair will beep 3-5 times before it starts the emergency lowering process.

If after following the reset procedure all 4 lights at the top of the hand control continue to flash or the chair is not operating smoothly, stop and seek technical help.



Electric Height and Tilt - continued

APPLIES TO THE FOLLOWING MODELS

IndiGo Drive HT
IndiGo HT
IndiGo HTM
IndiGo HTR
IndiGo Plus HT
IndiGo Plus HTX

Emergency stop

In case of emergency, the electrical system of the chair can be switched off by pressing the red "Stop" button on the hand control until it beeps and LEDs 5 & 6 light up.

The emergency stop button is deactivated by pressing "STOP" until LEDs 5 & 6 turn off.

**Emergency lowering**

If the side button on the hand control cannot lower the chair. Hold down the red "Arrow down" on the hand control until the chair is automatically lowered. The chair will beep 5 times before it starts the emergency lowering process. While the emergency "Arrow down" button is held down, the power LED will flash.

Battery and control box LED indicators

The battery and control box LED indicators can be found under the white cover plate.

Control box LED.

Green light = power plug is connected.
No light = Not connected to power.

Battery box LED.

Lights when power plug is connected.
Yellow light = Charging.
No light = Fully charged.

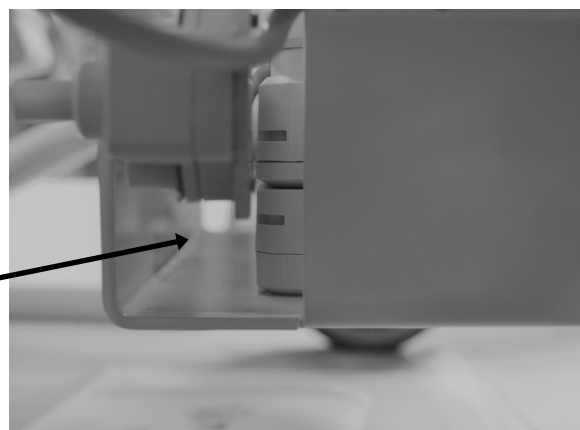
**Control box connections**

1. Cable to back actuator
2. Cable to right height actuator
3. Cable to battery box
4. Cable to left height actuator
5. Cable to hand controller

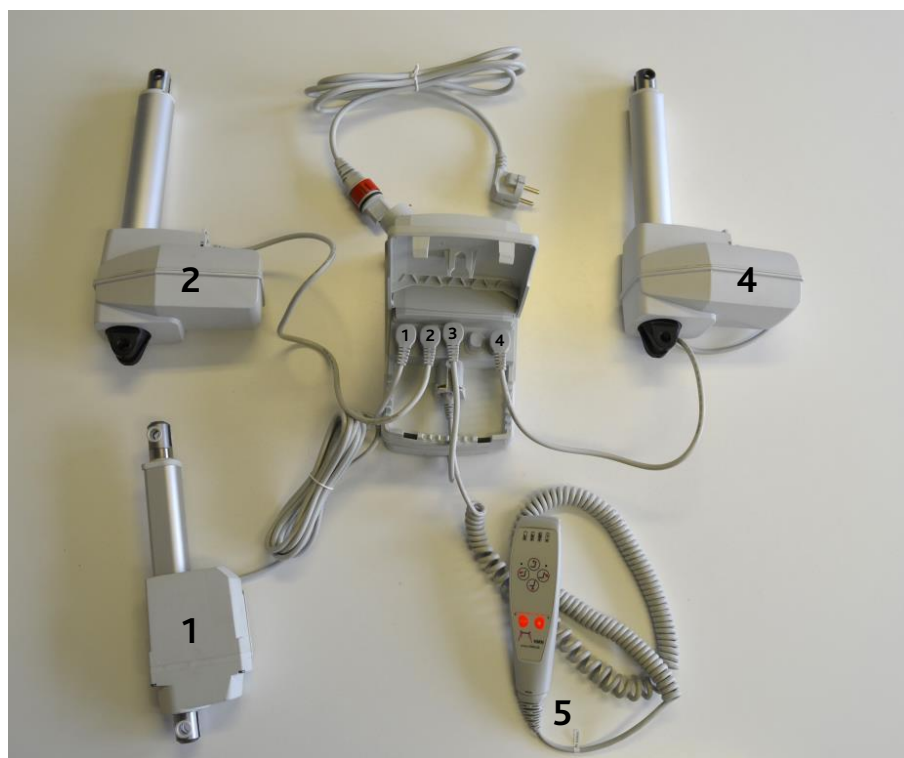

Trouble Shooting/guide

As a first course of action concerning electrical issues, always try to charge the chair for 24 hours.

Only the left/last battery light is on

The chair is low on power and must be charged. The chair will not elevate if only 1 battery light is on.

The 2 small LEDs either side of the arrow buttons are lit

The emergency STOP has been activated. It must be deactivated by holding down the emergency stop button on the hand control until the chair beeps once and the 2 small LEDs either side of the arrow keys go out.

All 4 lights at the top of the hand control are flashing

If all 4 lights at the top of the hand control flash the control box has received an error signal. To reset the error follow steps 1 & 2:

Step 1) Hold down the "stop" button on the hand control until the two LEDs either side of the arrow keys light up

Step 2) Hold down the emergency red "Arrow down" button on the hand control until the chair is automatically lowered to the bottom. Note: The chair will beep 3-5 times before it starts the emergency lowering process.

If after following the reset procedure all 4 lights at the top of the hand control continue to flash please contact us so we can offer technical assistance..

No LEDs on the hand control are on and the chair can't elevate or tilt

1) Check that all the wires are correctly plugged in, see 'Control box connections'.

2) Try charging the chair for 24 hours after checking the wires.

If the problem continues after this it might be a defect battery or other electrical components.

The chair is elevating unevenly

The chair isn't elevating properly and the chair is being pulled sideways.

The actuators on the chair will not always go at the same speed. This might result in slightly tilted seat frame.

In this case lower the chair completely to reset the pistons in the actuators.

The chair continues to pull sideways

If the chair continues to pull sideways there could be a problem with an actuator.

Do **NOT** try to elevate the chair in this case.

Send us pictures of the frame from the front and back so we can offer technical assistance.



Charging the chair.

If the chair won't charge

Check that the outlet you are using has power and that it is turned on.

The chair won't start charging, the LED indicating charging on the hand control is not blinking

When you start the charging process the system prepares the battery to receive power and LED 4 will light up.

Once the system is prepared charging will start and LED 4 will flash.

When fully charged LED 4 will light continually.

The system will take longer to prepare if the battery is cold, or the chair is very low on power.

In the event that charging does not start the chair will need to be reset, follow steps 1 & 2:

Step 1) Hold down the "stop" button on the hand control until the two LEDs either side of the arrow keys light up

Step 2) Hold down the emergency red "Arrow down" button on the hand control until the chair is automatically lowered to the bottom. Note: The chair will beep 3-5 times before it starts the emergency lowering process.

The charging light on the hand control is not lit or blinking when the chair is plugged in to an outlet

- 1) Check that the charging wire connected to the control box is correctly plugged in.
- 2) Check that the red locking ring is mounted inside the plug on the control box, when mounted correctly it can be seen through the plug.

If both the charging wire is connected and the red locking ring is correctly mounted then check the condition of the battery.



The chair won't charge every attempt.

If you experiencing occasional charging problems try and reset the chair as described above.

Check that all the wires are correctly plugged in, see 'Control box connections'.

If the problem continues contact us for further advice.

The chair will only work occasionally, even after a reset.

Check that all the wires are correctly plugged in, see 'Control box connections'.

If the problem continues contact us for further advice.