

# TOMMI Compact Nursing Bed User Manual



Paediatric nursing bed has been designed to meet the specific needs of smaller users

## IMPORTANT!

The TOMMI Compact Nursing Bed for home care and independent living is a class 1 medical device. It has been designed and manufactured in compliance with the EN standards 60601-2-38 and EN 1970.

Design, manufacturing, repair and sales activities are certified by the TÜV body according to ISO 9001 and ISO 13485.

It is not to be used as a stretcher.

## TECHNICAL FEATURES

- **Overall Dimensions:** 1810x 830mm. **Sleeping dimensions:** 700x1700 **Net weight:** 45 Kg
- **Maximum Safety Load:** 100kg
- **Parts Weights:** **chassis:** 10.8 kg; **cross brace:** 15.2 kg; **mattress platform:** 26 kg. Each of these main parts is labeled with the bed serial number; please do not mismatch them with those from another bed.
- **Height** from floor to mattress platform (without mattress) with casters diameter 100 mm: **Mini:** 295mm **Maxi:** 820mm
- **Back rest:** **length:** 565mm; **Max Angle:** 85° (do not lift up the legs section in this position)
- **Raised legs section:** **length:** 850mm **angle:** from 0 to 20°
- **Thigh section:** **length:** 300mm **angle** from 0 to 30°
- **Foot section:** **length:** 550mm **angle** from 0 to 30°
- **Central part: (seating position):** 285mm
- **Electrical parts :**
- **Mains :** 220/230V class 1 type B; two primary fuses T0.8, intensity 0.8A, earthing, protection category: IP 66, intermittent duty/AB 2 min/ 18 min. Electromagnetic compatibility in compliance with EN 60 601.1.2/ 2001 version.
- **Noise level:** below 55db.

## OPERATING INSTRUCTIONS

1. **Handset:** see user leaflet for the handset
2. **Service and maintenance:** refer to the installation and preventive maintenance sheet as well as instructions here
3. **CPR facilities:** you need two people: Unplug the bed from the mains, one person holds the backrest and the other removes the locking pin that holds the actuator to the bed, and then both bring down the backrest to a flat and horizontal position.
4. **Individual breaking:**

To break, push down on the break with your foot to release the break,



lift up the break with your foot

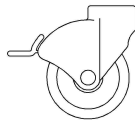

## SPECIFIC INSTRUCTIONS

- Not to be used by a child under 3 and above 12, not to be used by a child weighing more than 80 kilos and taller than 150 cm.
- The bed must only be used indoors in the following environmental conditions: temperature between 10° and 50° C, humidity between 20 and 85%.
- The bed should only be used on a flat, clean and horizontal surface.
- Breaks must be on at all times when the bed does not need to be moved, and in particular when the patient goes in or out of his bed, when the sleeping surface is not at its lowest position, when the motors are in use and when care is provided..
- Before moving the bed, unplug the bed from the mains and et roll the cable onto the cable tidy
- When the patient is in the bed, the angle between the back rest and the legs section must always be superior to 90°
- Please read the user guide carefully, this item must always remain available to the patient or the carer.
- Follow precisely the safety instructions at the back of the user guide.
- Please read the paragraph « preventive maintenance »
- Always position the bed pole in the notches to prevent it from rotating
- Before using any accessories you must read the user guide provided with it
- Please check the cables and connections to the control box :
  - option : separate remote lock out of the electrical functions
  - handset
  - back rest actuator
  - variable height actuator
  - legs sections actuator

## SPECIFIC INSTRUCTIONS CONT.

- Make sure you always put back in place the anti pull-out cable device on the central unit
- Make sure the cables are never pinched, flattened, sheared or entangled
- Check that the intermediary cable grommet is properly tightened in the anti-pull out cable device on the chassis, otherwise tighten it again with a wrench
- When using the bed in connection with electro-medical (IV or intracardial) devices, make sure connect the specific earthing cable (delivered separately) between the equipotentiality plug on the mattress support and the earth connection on the chassis
- We recommend you use a mattress with dimensions 680mm x 1680mm, 140mm thick

## INSTRUCTIONS FOR PREVENTIVE MAINTENANCE

An acknowledged and authorised technician with correct eyesight should perform preventive maintenance at least once a year and throughout the lifetime of the bed.

The cardboard sheet for preventive maintenance joined to this leaflet details the operations and checks that have to be performed

## INSTRUCTIONS FOR CLEANING AND DISINFECTION

- The TOMMI bed must not be immersed in water or cleaned with a high-pressure system.
- The bed should be cleaned with a damp sponge and soap or a disinfecting cloth.
- For instance: SURFA'SAFE by ANIOS
- Unplug the bed from the mains before cleaning the bed.
- Do not use acid, alkaline products or solvents such as acetone or cellulose diluent.
- The electric set up is IP 66 throughout; for this reason check that all connections to the central unit are effective.

## PROTECTION OF THE ENVIRONMENT

When the bed is not in use anymore and due to be destroyed, its electrical components should be disposed of in a specialised recycling bank, the other elements (steel, plastic and wood) can be considered and disposed of like normal domestic waste.

## TROUBLESHOOTING

Description of the problem	Possible cause	Remedy
The orange indicator for the mains on the handset is off	1) the bed is not plugged to the mains 2) a fuse has blown 3) the central unit is faulty 4) the handset is faulty or its cord is torn off	1) plug the bed to the mains 2) check both the main cable and the handset cord 3) check the handset 4) replace the central unit
The orange indicator for the mains is on but the motor does not work. The relay in the central unit makes a “clinking” sound	1) the motor connector is not properly plugged into the central unit 2) the motor is faulty 3) the central unit is faulty	1) plug in the motor connector properly 2) replace the motor 3) replace the central unit
Le voyant secteur s’allume mais le moteur ne tourne pas. Les relais de l’unité centrale ne produisent aucun bruit.	1) the central unit is faulty 2) the handset is faulty 3) those functions are not allowed/locked 4) the red « plug » is not properly pushed in	1) replace the central unit 2) replace the handset 3) unlock those functions 4) push in the red « plug »
L’unité centrale fonctionne correctement sauf dans une des sorties	1) check the connections 2) the handset is faulty 3) the central unit is faulty	2) replace the handset 3) replace the central unit
Le moteur tourne mais l’axe reste immobile	The pinion gear or the drive shaft is damaged	Replace the motor
Le moteur ne parvient pas à soulever la pleine charge	The motor is damaged	Replace the motor
La tige du vérin ne bouge et le vérin tourne	The safety nut has been removed	Replace the motor

Electrical parts are warranted; the protection category is IP66; please do not attempt to open the motors: the warranty would not be valid anymore and the motors would not be waterproof anymore.

Only staff from an authorised dealer can open and work on the electrical parts.

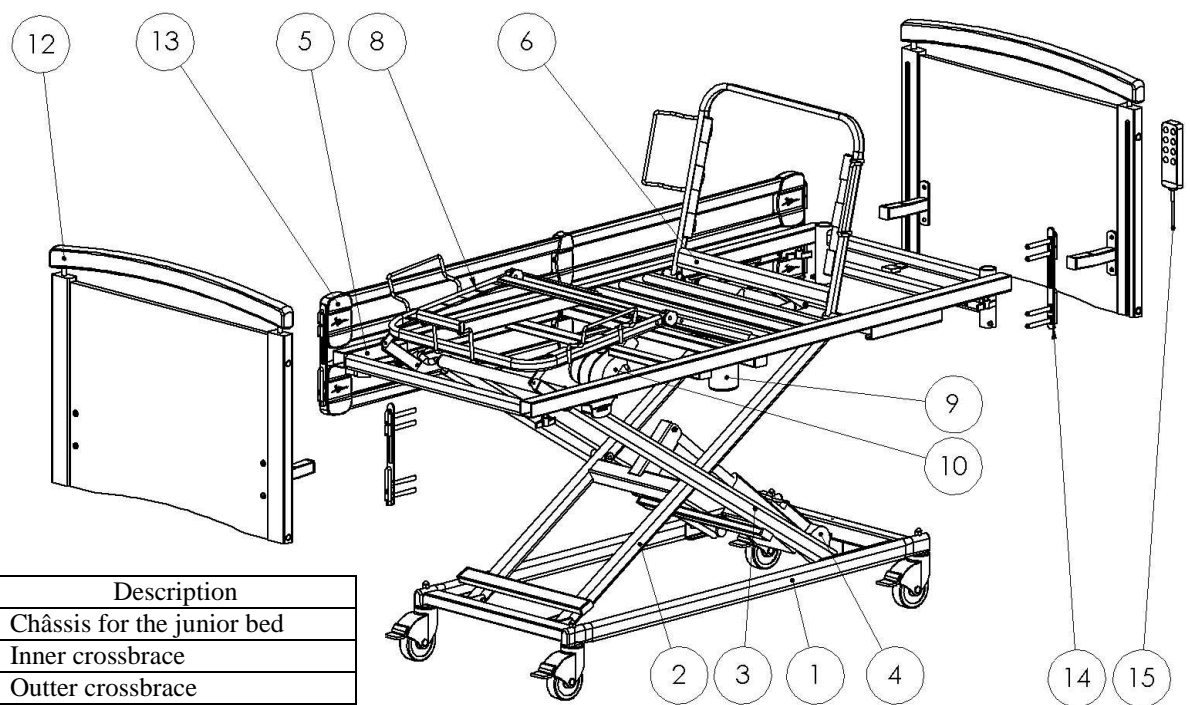
**IMPORTANT!**

rep	nb	reference	Description
1	1	LEO 1005	Châssis for the junior bed
2	1	LEO 1007	Inner crossbrace
3	1	LEO 1006	Outer crossbrace
4	1	SV3929	Actuator for variable height ref 62373
5	1	LEO 1008	Junior mattress platform
6	1	LEO 1009	Junior back rest
7	1	LEO 1010	Junior thigh section
8	1	LEO 1011	Junior foot section
9	1	SV 3903	Back rest actuator référence 50224
10	1	SV 3955	Legs rest actuator reference 57937
11	2	QC0003	Small rackgear for legs section
12	1	PBE 1034	Junior end board PX3340
13	1	BAO 1080	Siderails BL 3145

## ASSEMBLY GUIDE

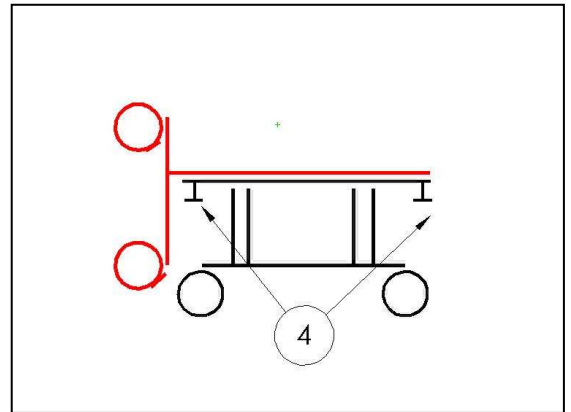
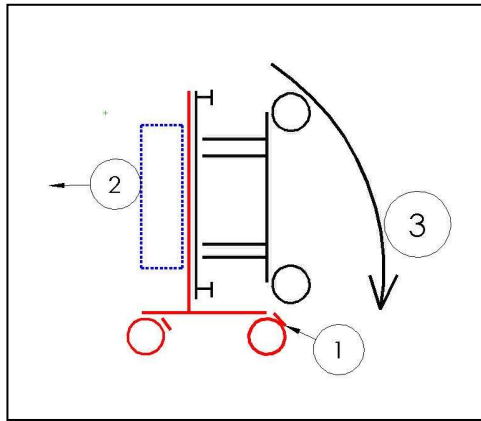

1. Use the breaks on the trolley
2. Remove the box of head and footboards
3. Tilt the bed towards you , check that Nothing is in the way
4. Unscrew the flynuts to remove the trolley and tighten on the end wooden boards.



push down the trolley breaks

When you tilt the bed towards yourself,



check that nothing is in the way behind you

**! CAUTION:** when you assemble or disassemble those bed parts you must always make sure the bed is on a flat and horizontal floor.

